

Data Sheet

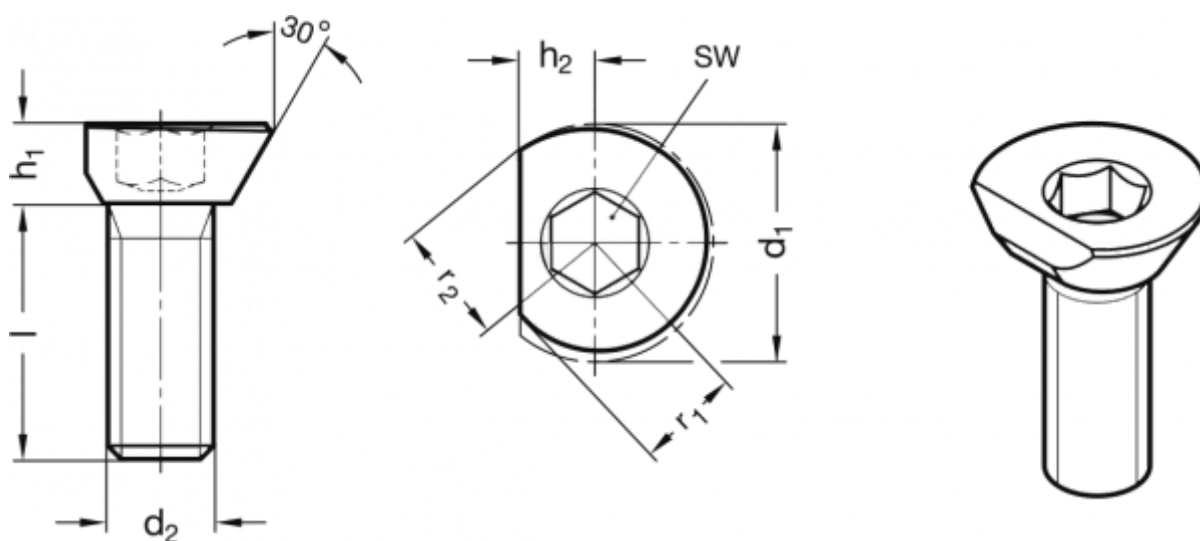

Article number: 20418218M816R
Description: E+G Cam point screw
GN 418-24-M10-24R

Measures



d1	= 18	s1	= 1.84
d2	= M 8	s2	= 1.2
h1	= 6	SW	= 5
h2	= 5.5	Torque max N m	= 22
L	= 16	x	= 6.6
Load capacity F (kN)	= 2.7	z	= 8
r1	= 7.7		
r2	= 9		